



EcoDose 2K

2K Dosing Unit

N10100003V

The **EcoDose 2K** is an electronic dosing system suitable for high and low pressure applications. It can be used in manual and automatic processes. Optimized for quick color changes and easy flushing, it enhances resource utilization and contributes to higher application efficiency. Fluids are measured consistently and precisely, even those media with different viscosities. Typical fluids handled are 1 or 2K materials, water and solvent based paints, varnishes, lacquers and monolayer paints.

CUSTOMER BENEFITS



[Flow rate measuring by Coriolis or gear flowmeter](#)

[High and constant mix accuracy](#)

[Monitoring of all dosing functions such as pot life, catalysis ratio and components A & B with dedicated alarm](#)

[Automatic color change controlled by volume](#)

[Independent flushing circuits for both components](#)

[Intuitive user interface for quick programming of individual settings](#)

[Optional remote maintenance \(via network\)](#)



Technical datasheet

EcoDose 2K

N10100003V

DIMENSIONS

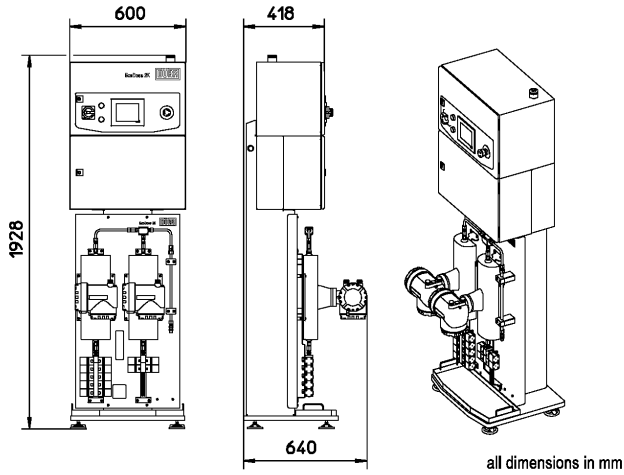

TECHNICAL ILLUSTRATION

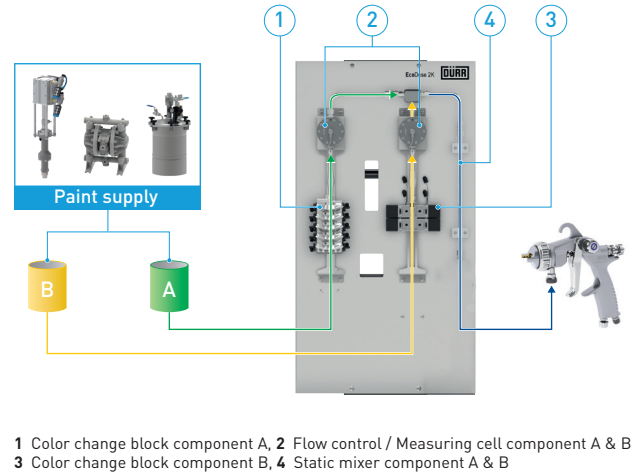

SPECIFICATION

Weight	160-190 kg
Type mixer	Static
Connector inlet, media	G1/8" (Female)
Connector outlet, media	G1/4" (Male)
Connector inlet, air	G1/2" (Female)
Connector outlet, air	G3/8" (Female)
Rated Power	0.3 kW
Pressure Air	5.5-8.0 bar (79-116 psi)
Fluid pressure inlet min.	1.0 bar (14.5 psi)
Fluid pressure inlet max.	20.0 bar (290.0 psi)
Flow rate fluid	0-6 l/min (0-0.26 gal/m)
Ratio	1:1-30:1
On-ratio accuracy	1.0 %
Material temperature range	15-40 °C (59-104 °F)
Viscosity min.	20 mPa.s
Viscosity max.	500 mPa.s
Ex Zone Fluid Section	Ex II 2G IIA T6
Protect. Class Switch Cabinet	IP55

Stated fluid pressure inlet and viscosity based on low pressure version. High pressure version: 20-200 bar (290-2.900 psi), 250-1.200 mPa.s Catalyst ratio, viscosity and flowrate depending on application.

Options for Europe and USA: mains voltage 230 or 110 V, nominal frequency 50 or 60 Hz

Illustrations are exemplary, depending on technical specification.