

## EcoGun AA AUTO

### Automatic air-assist spray gun

Automatic air-assist spray guns are often used in batch paint application where they are a part of the automated painting process. They are characterized by a material path made of stainless steel and a separate air regulation for round and flat spray patterns, while the seal packing is externally adjustable.

#### CUSTOMER BENEFITS



[Air-assist and airless work mode possible](#)

[Material pressure up to 250 bar \(3,600 psi\)](#)

[Material path completely made of stainless steel](#)

[Needle seal accessible from the outside](#)

[Separate round/flat spray regulation  
\(for ACV or RC version\)](#)

[Wide range of nozzles available](#)

[Material circulation or direct material supply](#)

[In-line filter available](#)



# Technical datasheet

## EcoGun AA AUTO

### DIMENSION

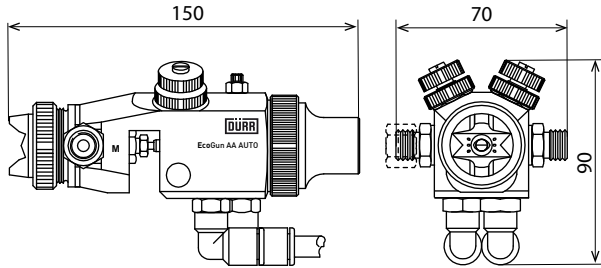

all dimensions in mm

### CHARACTERISTICS

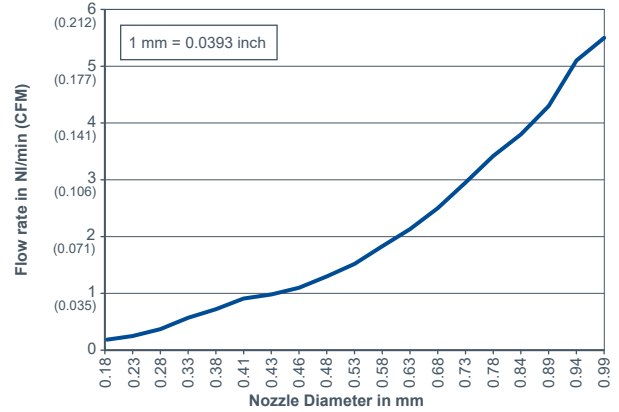

Flow rate for water / Pressure 100 bar

### SPECIFICATION

Weight	644 - 688 g depending on gun variant
Material contact	Stainless steel
Ex zone	Ex II 2G T6 X
Dimensions	150 x 87 x 76 mm
Connector media outlet	G 1/4 (Male)"
Connector media inlet	G 1/4 (Male)"
Connection pressure	< 250,0 bar (< 3.626,0 psi)
Compressed air quality (ISO 8573-1)	ISO 8573-1:2010 [1:4:2]
Temperature media	< 60 °C
Spray jet width SB 50%	50 - 510 mm
Spray distance	250 - 300 mm
Viscosity	< 4.000 mPa.s
Material gaskets	FEPM, PTFE

### ORDER NUMBERS

Part No.	Description	Atomization air regulation
N36230157	EcoGun AA AUTO XC N N ACV N P8(6/4) N	Manual - knobs
N36230152	EcoGun AA AUTO XC N N FRC N P8(6/4) N	Remote
N36230158	EcoGun AA AUTO XC N N RC N P8(6/4) N	Remote

Note: Spray gun is delivered without nozzle, they need to be ordered separately.

# Technical datasheet

## EcoGun AA AUTO

### NOZZLE SELECTION

Spray angle	Size [mm; inch]
10°-40°	0.18/0.007
10°-60°	0.23/0.009
10°-70°	0.28/0.011
10°-80°	0.33/0.013
10°-90°	0.38/0.015

Please check webshop for complete range of nozzles.

### TECHNICAL ILLUSTRATION

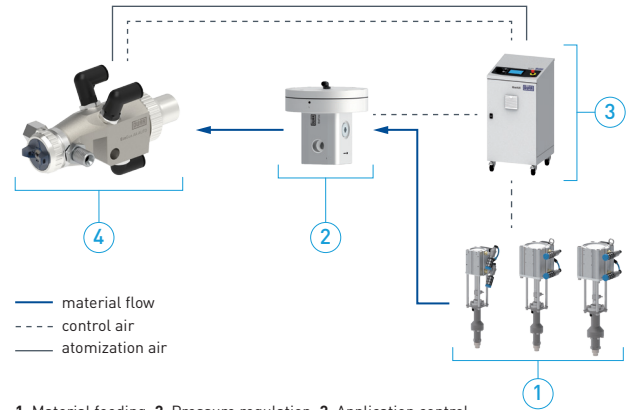

- 1 Material feeding, 2 Pressure regulation, 3 Application control,  
4 Automatic spray gun

### ACCESSORIES

Part No.	Description
M33120007	Adjusting plate cpl. <b>EcoGun AA AUTO</b>
M34040020	Paint pipe with filter G1/4"
M41090200	Locking screw M10 SW17 L13,5
M55030171	Elbow screw connection adjust. G1/4-G1/4
M55030173	Elbow screw con.adjust.G1/4"-1/4"NPS(M)
M59012317	Covering <b>EcoGun AA/AS AUTO pro/pro HD</b>
N36960037	Cleaning kit 17 pc
N36960038	Cleaning kit 21 pc

Part No.	Description
N66030005	Bracket <b>EcoGun</b>
W20910224	Protective overall <b>EcoGun AS AUTO</b>
W33130004	Cleaning needle 33mm 0,011"-0,017" 12pcs
W33130005	Cleaning needle 33mm 0,017"-0,021" 12pcs
N36960267	Kit nozzle cleaning f. AA-guns
N08010047	DIN Cup 4 mm
N08010053	DIN Cup 2 mm
N08010054	DIN Cup 6 mm

# Technical datasheet

## EcoGun AA AUTO

### SPARE PARTS

Part No.	Description
M35030077	Air cap 10-30° 6-KT
M35030078	Air cap 40-90° 6-KT
M35030229	Air cap round
M30010385	Union nut with gasket <b>EcoGun AA AUTO</b>
N36960100	Tool and connector kit <b>EcoGun AA AUTO</b>
M55170051	L screw fitting 1/4"NPT x 1/4"
M55170053	L screw fitting R1/4" X 6mm
M57310085	Screwed elbow push-in connection D4 R1/4
M55170052	L screw fitting 1/4"NPT x 3/8"
M57310089	Screwed elbow push-in connection D8 R1/4
N36960141	Connector kit robot EU
N36960142	Connector kit robot US
M41090197	Locking screw M14x1
M57930010	Restrictor cpl.ATM IV <b>EcoGun</b>
M57930028	RESTRICTOR\KPL. ATM IV WERKZEUGVER-STELLB
N36960288	Plug kpl. <b>EcoGun AA AUTO</b>
N36960101	Sealing kit <b>EcoGun AA AUTO</b>
N36960099	Repair kit <b>EcoGun AA AUTO</b>
M67010085	Piston piston axis cpl.
M08220022	Leak-proof collar (4pcs)
N36960132	Needle kit <b>EcoGun AA AUTO</b>

Part No.	Description
M56100470	Reducing nipple M10 1/4" SST
M68010238	Pressure spring d2,0 D10,0 Lo34,50
M68010241	Pressure spring
M08280049	Gasket D22,03 d17,95 L2,0 PTFE
M08010529	Packing ring D13,1 d10,2 s1 AlMgSi1
M41060166	Special screw with packing washer
M08030770	O-ring 4x1,2 75 shore viton extr.
M32020215	Needle part cpl.
M08320003	Needle gland M8x1 d3,2 L15 SW8
M08220020	Leak-proof collar D6,4 d2,8 L3 PTFE
M08080062	Packing washer D6,4 d3,4 s1,5 SST
M30050079	Special nut M3 SW10 L7 Ms
M30050076	Special nut M3 SW4 D5,6 L14,5 Ms
M30050073	Special nut M12x1 s6,5 SST
M30050074	Special nut M6x0,75 L4,5 SW7
M03010361	Seat seal cpl.
M08280048	Gasket D7,6 d3,3 L1,5 PA-6
D09140095	Set screw M5x20 DIN914 1.4301
D09340024	Hexagon nut M5 DIN934 1.4305
M25010070	Locking cap with bushing
M30010317	Union nut D43 d37,1 L12 Ms